



COLOMER & SONS

---

Users Manual - Model: Clotilde II

---

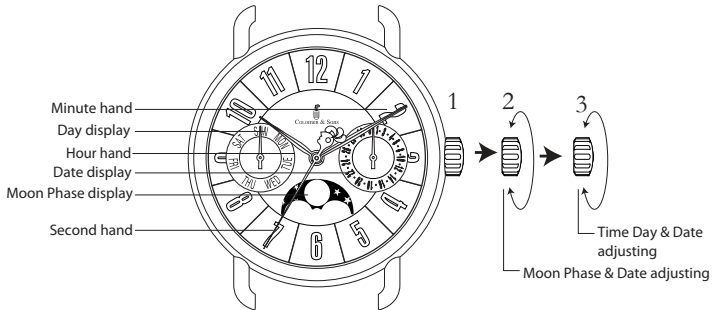

**1) SETTING THE DAY AND TIME (HOUR, MINUTE AND SECOND)**

The hour, minute, second and day are set by the same operation.

**2) SETTING THE DAY**

Pull the crown out to the 3rd position to stop the second hand at 0 (12 o'clock). Turn the hour/minute hands in a clockwise direction to set a day.

In order to set the day, you must advance the hour hand by 24 hours per day. NOTE:

\* If the day is set by turning the crown counterclockwise, there is the possibility the date will not change over.

Do not set the day by turning the crown in counterclockwise direction.

\* The day changes somewhere between 0:00a.m. and 5:30a.m. or a little later.

**3) SETTING THE TIME**

After setting the day, set the hour and minute hands.

Turn the hour/minute hands in a clockwise direction to set the time.

To ensure time is set accurately, first turn the minute hand 5 minutes ahead of desired time and then turn back (in a counterclockwise) to the desired time.

After setting the time, use a time signal to synchronize the watch by pushing crown to the normal position to start the second hand going.

**NOTE**

Make sure you have correctly set AM/PM before setting the time.

When the day changes over, it is a.m..

(Day changes over between 0:00a.m. and 5:30a.m. or little later)

---



## COLOMER & SONS

---

### Users Manual - Model: Clotilde II

---

#### D) SETTING AND READING THE AGE OF THE MOON

\* The moon phase represents the age of the moon, the actual shape of the moon during each phase is not represented.

\* Use the moon phase only as a guide to the age and phase of the moon when reading and setting watch.

#### D-1) SETTING THE AGE OF THE MOON

Pull the crown out to the 2st position.

Turn the crown clockwise to advance the moon phase.

#### D-2) SETTING THE AGE OF THE MOON WITH AGE SCALE

\* Check on the age of the moon for the day. Check the newspaper or other source for the age or phase of the moon for today or tomorrow. Subtract one day before a setting is made if the listings for tomorrow are used.

\* Setting procedure (Example: age of the moon:4.4)

Pull the crown out to the 2st position.

Turn the moon disc clockwise until the center of the moon is in line with 4.4 on the scale.

#### D-3) SETTING THE AGE OF THE MOON WITHOUT THE AGE SCALE

\* Check the newspaper or other source that lists current age or phase of the moon. Referring to section D) Reading the age of the moon , set the moon phase to the age (0,7,15 or 22) closest to the listed.

More accurate setting can be made at the same time of the new moon (0) or full moon(15).

#### THE AGE OF THE MOON

The age of the moon is indicated in units of days. The average period from a new moon to the next new moon is equivalent to about 29.5 days.

#### E) SETTING THE DATE (BY QUICK OPERATION)

Pull the crown out to the 2st position. Turn the crown counterclockwise to set the date quickly.

#### NOTE:

\* Do not set the date between the hours 9:00p.m. and 0:30a.m..The date may not change correctly the next day.

