

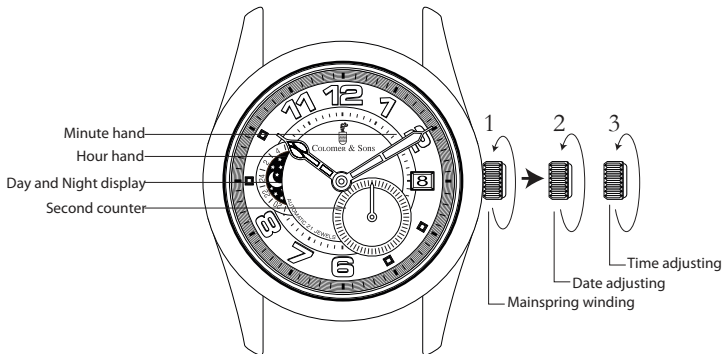

COLOMER & SONS

Users Manual - Model: Timeless Day and Night



1) START

Being an automatic watch we suggest you wind it up completely the first time you use it (Position 1) Unscrew the crown and in this position rotate the crown will need to be wound manually 15 – 20 times to develop a sufficient power reserve to ensure the accuracy of the timepiece. You do not have to repeat this action every day while the watch is in use, the watch will charge itself automatically.

2) ADJUSTING TIME

Rotate the crown in "3" position and adjust the standard time. Then check if it is morning or afternoon and adjust correctly.

3) ADJUSTING DATE

Position "2" Turn the crown clockwise to set the date.

* If the date is set between the hours of around 9:00 PM and 1:00 AM, the date may not change on the following day.

- Important: After any operation make sure to screw the crown back to normal position 1 perfectly straight and closed. If the crown is not perfectly closed and straight it might be possible that water could enter into the watch.
