

USER INSTRUCTIONS

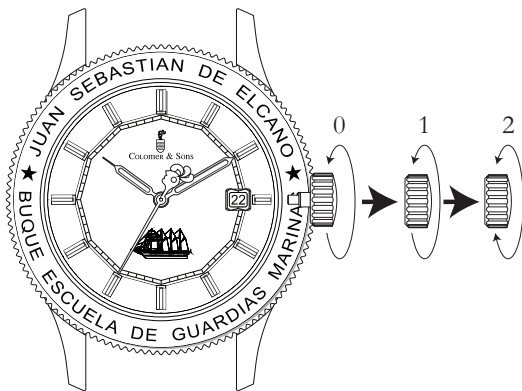

1.Start:

First unscrew the crown in a clockwise direction, whenever you want to make any change to the watch.

Being an automatic watch we suggest you wind it up completely the first time you use it (Position 0) The crown will need to be wound manually 15 – 20 times to develop a sufficient power reserve to ensure the accuracy of the timepiece. You do not have to repeat this action every day while the watch is in use, the watch will charge itself automatically when in use.

2. Setting of the time:

Pull out the crown (Position 2) and move the hands to the desired time.

3. Adjusting the date:

There are 2 ways of doing this:

- a) By Pull out the crown (Position 1) , Turn the crown in the opposite direction from clockwise to set the date.
- b) When adjusting the time every 24 hours by moving the hands (Position 2). If the month has fewer days, it must be adjusted manually.

Note:

4. The date changes somewhere between 11:00 pm and 12:30 a.m. hours.